



# BEAUTY CARE

## CATALOGUE



# MOULDING THE FUTURE

At ExactoCraft, we are committed to providing our customers with a customer-centric business model, ensuring an exceptional experience throughout the entire process, from prototyping to delivery. Our long-standing success is attributed to our unwavering dedication to unparalleled quality and exceptional service for over 74 years.

With a history dating back to 1948, we have established ourselves as a prominent leader in the field of techno plastic design, tooling, and injection molding. Our commitment at ExactoCraft is to deliver top-quality plastic product solutions to both national and international markets. We achieve this by leveraging our extensive engineering expertise, innovative design capabilities, and cutting-edge polymer technology.

Our highest-quality beauty care and cosmetic products are crafted with carefully selected materials that will delight consumers. At ExactoCraft, we prioritize the look, feel, and practicality of our products, which has resulted in award-winning designs for our valued customers.

With our comprehensive range of services, including product development, branding, and assembly, we guarantee consistently exceptional and stylish product packaging.



BODY SPRAY  
**ACTUATORS**



# EXACTO Unisex Actuator

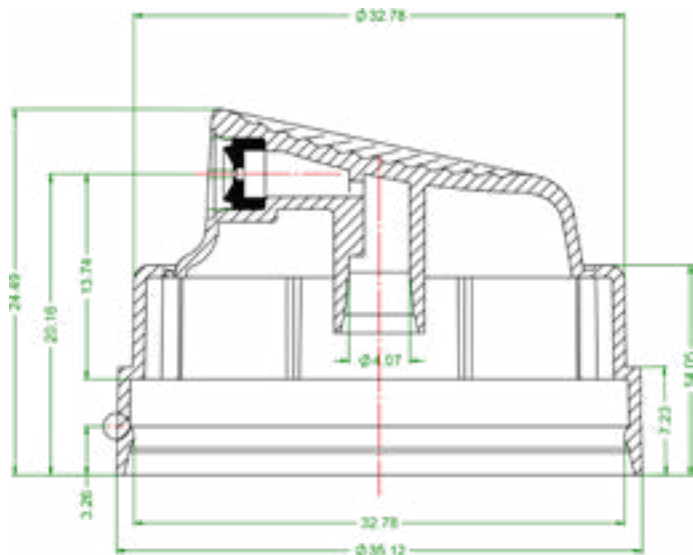

Experience the perfect blend of style and functionality with our **Exacto Unisex Spray Actuator**. With its sleek design, this spray actuator not only adds a touch of elegance but also provides a practical and appealing look. Its seamless compatibility with a standard 32 mm aerosol valve ensures effortless integration, making it the perfect choice for your aerosol needs.



ILLUSTRATED ON 45 MM CAN

# EXACTO Female Actuator

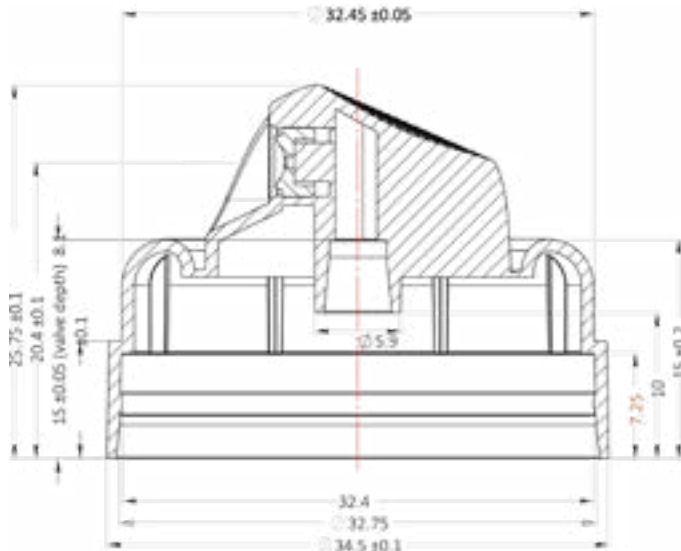

Embrace the power of femininity with our **Exacto Female Spray Actuator** and make a bold statement in the world of aerosols. This actuator exudes flair and fun with its sleek and petite design, offering a more refined look compared to our Unisex actuator. Crafted to perfection, it seamlessly fits onto a standard 32 mm aerosol valve, ensuring effortless functionality and compatibility.



ILLUSTRATED ON 38 MM CAN

# EXACTO Actuator Caps

**DOMED OVER CAP:** 44 mm(D) x 43 mm(H)  
Internal "stove pipe" that clips onto Exacto actuator.  
Outer rests on shoulder of can.  
Fitment options available from 32 mm - 52 mm can.  
Available in Gloss.

**FLAT ACTUATOR CAP:**  
34 mm(D) x 25 mm(H)  
Clips and rests on Exacto Actuator.  
Available in Gloss.



**FLAT OVER CAP:** 44 mm(D) x 43 mm(H)  
Internal "stove pipe" that clips onto Exacto actuator.  
Outer rests on shoulder of can.  
Fitment options available from 32 mm - 52 mm can.  
Available in Gloss or Matt.

**DOMED ACTUATOR CAP:** 34 mm(D) x 25 mm(H)  
Clips and rests on Exacto Actuator.  
Available in Gloss.

COSMETIC



JARS



# 50 ml Double-Wall Jar & Lid (PP)

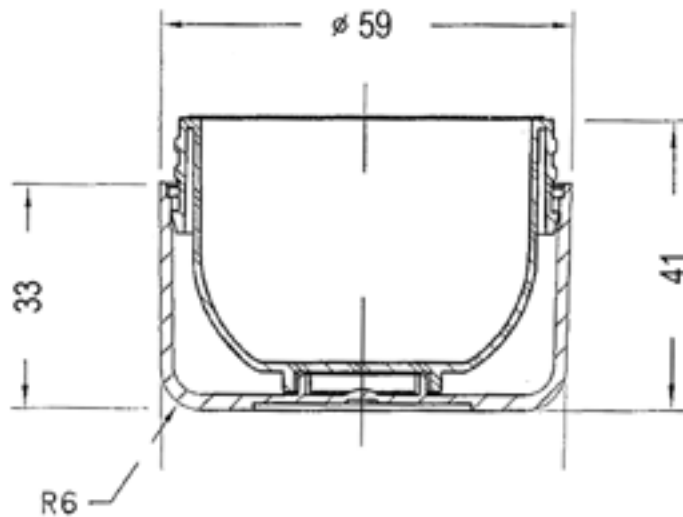

These **50ml double-wall jars** are designed to add a touch of sophistication to your products. Made entirely from Polypropylene, these jars are not only fully recyclable but also offer chemical resistance, allowing you to extend the shelf life of your products. We have the ability to perfectly match any pantone color and offer the options of heat-transfer printing and foil printing, giving your product that unique, competitive edge.





# 50 ml Double-Wall Jar & Lid (SAN)

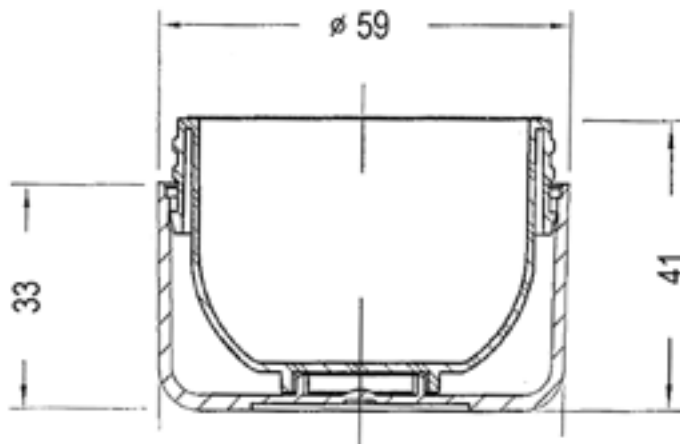

Our **50 ml SAN** cosmetic jars not only offer the luxurious feel of a premium glass jar but also add a touch of elegance to your product. We've got you covered with limitless colour possibilities. Our team can match any pantone shade and offer the options of heat-transfer printing and foil printing, giving your product that unique, competitive edge.



# 250 ml Double-Wall Jar & Lid (PP)

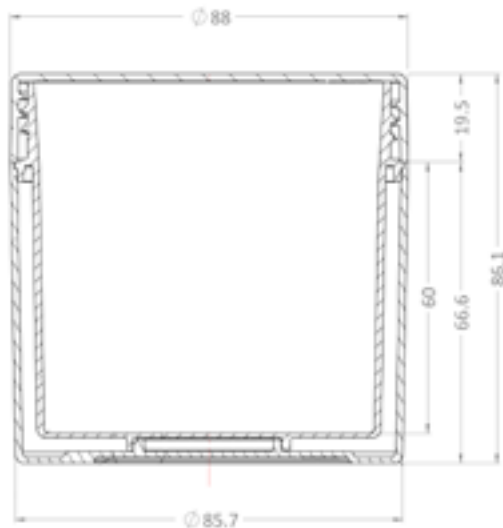

A classy yet uncomplicated solution for all your larger volume requirements. Made entirely from Polypropylene, these **250 ml Double-wall jars** are not only fully recyclable but also offer chemical resistance, allowing you to extend the shelf life of your products. We have the ability to perfectly match any pantone color and offer the options of heat-transfer printing and foil printing, giving your product that unique, competitive edge. Perfect for body skin care products and more!.



# 10 ml Jar & Windowed Lid (SAN)

Our innovative **SAN 10 ml jar**, is expertly designed to seamlessly blend practicality and creativity into a compact and convenient package. But that's not all - our game-changing Window & Rim combo lid takes this jar to a whole new level, unlocking a world of endless creative possibilities.

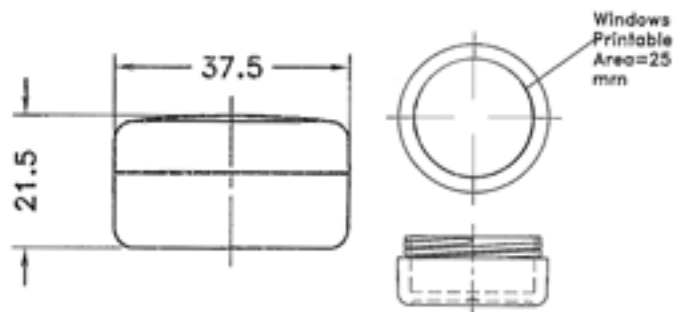

# LIP BALM CONTAINERS



# Luxury Cold-fill Lip Balm Container & Cap



This **cold-fill lip balm container** is highly popular and adored by millions of consumers! It offers a smooth glide and effortless usability, whilst providing a convenient filling process for manufacturers. Standard fill volume is 4.5g - 5g of product. We have the ability to perfectly match any pantone color and offer the options of heat-transfer printing and foil printing, giving your product that unique, competitive edge. Perfect for body skin care products and more!

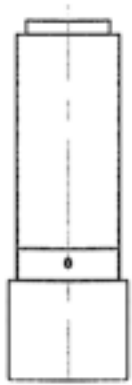

# Hot-fill Lip Balm Container & Cap

A budget friendly **hot-fill lip balm container** option, perfect for the fast moving, affordable ranges. Made entirely from Polypropylene, these jars are not only fully recyclable but also offer chemical resistance, allowing you to extend the shelf life of your products. We have the ability to perfectly match any pantone color and offer heat-transfer printing, giving your product that unique, competitive edge.

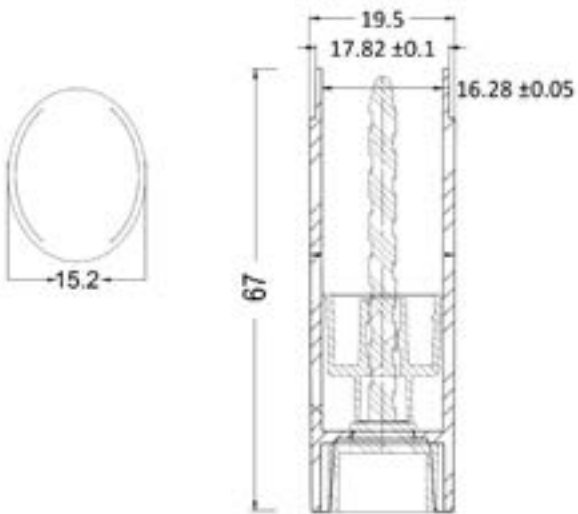

# BOTTLE CLOSURES



# Flat Cap for 24/410 Thread

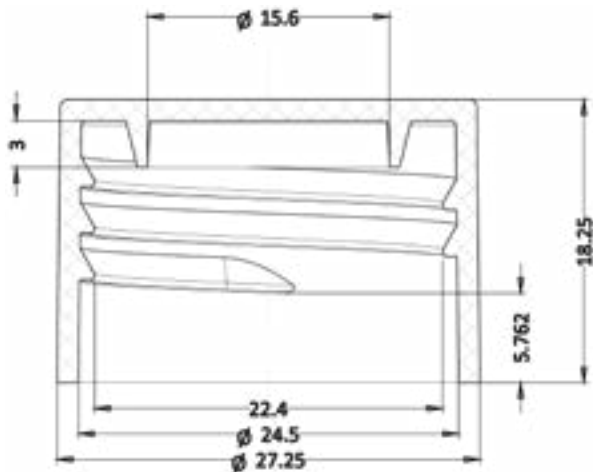
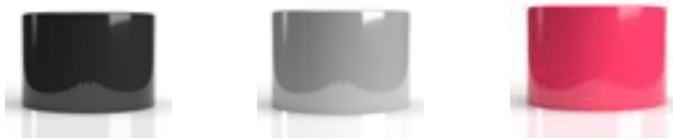

Crafted with precision, our **24/410 Flat Caps** guarantee an airtight closure, ensuring the freshness and integrity of your product. Say goodbye to worries about leaks or contamination, and embrace the peace of mind that comes with knowing your product is perfectly sealed.





# Disc-top for 24/410 thread

Say goodbye to spills and wastage, and embrace the efficiency and elegance of our **24/410 disc top** bottle closure. Crafted with utmost precision, this innovative closure guarantees an airtight seal, preserving the freshness and quality of your product like never before. The convenience of its perfect dispensing function ensures effortless and precise application every time.

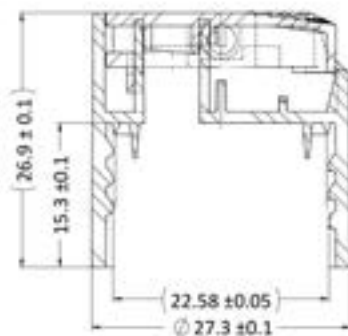



## CAN'T FIND WHAT YOU'RE LOOKING FOR?

At Exactocraft, we pride ourselves on being industry leaders in custom product design and development. With our unparalleled expertise and passion for innovation, we offer a comprehensive range of services to bring your ideas to life.

From the initial conceptualization and design phase to the creation of prototypes, our talented team of designers and engineers will guide you through every step of the process.

Whether you need a completely new product or improvements to an existing one, we have the knowledge and resources to turn your vision into reality. Trust Exactocraft to deliver exceptional results and exceed your expectations in custom product design and development.

Visit [www.exactocraft.com](http://www.exactocraft.com) for more

